

SM-100 SHOPBUS MODULE

XM range

The Nexmosphere XM range offers Xperience Controllers in a configurable and extendable form factor making it ideal to use when functionality combinations that aren't available in the smaller ranges are required. This series consists of XM controllers and EM extension units, which are mounted together at our production facilities in order to offer you just the right functionality set for your project.

ShopBus Modules

ShopBus modules are specifically designed for two reasons; firstly, creating large systems where more interfaces are needed than one XM controller with connected EM modules can provide. And secondly; allowing large interspacing between several control units, when Elements are needed far apart from each other. The Shopbus architecture enables connecting multiple control units, with the possibility of using long cable lengths between the units. All the while, the interfacing towards the connected device can still take place through one serial connection.



Features

- 8x X-talk interface for easy sensor connection

X-talk interface

Connect a wide range of sensors, buttons, LEDs, or any other of the Nexmosphere Elements to create your unique shopper experience. Due to auto-configuration, no additional setup is required for seamless operation.

- Plug and smile interface
- Compatible with any of the Nexmosphere Elements
- Providing power to the connected Elements for easy system wiring

ShopBus

- Connect Shopbus modules as far as 25 meters away from the XM controller using the ShopBus interface -and cable.
- ShopBus cables are available with and without power feed-through (with power feed-through = red, without = black).
- Daisy-chain up to 8 ShopBus modules onto 1 XM controller
- Additional power input possible on each ShopBus module for applications that require higher amounts of power.

Benefits

- Auto start-up and configuration for highly reliable standalone applications (24/7 operability)
- Create large-size setups that can be controlled through one single serial connection using the X-script API
- Combine any of the ShopBus module and XM modules to make an exact fit for your application



SM-100 SHOPBUS MODULE

Thermal specifications

Operating temperature: +10°C...+40°C/ +50°F ... +104°F
 Storage temperature: -20°C...+50°C/ -4°F ... +122°F
 Cooling: Passive cooling (no moving parts)

Electrical specifications

Operating voltage: 5VDC
LPS power adapter (2.0A)
 or powered via
 ShopBus-In socket (max 1.0A)
 Max. system current: 2.0A
 Power consumption: 0.2A
 Max. output per X-talk interface: 500mA @5VDC
 Max. output on ShopBus Out interf.: 1.0A @ 5VDC

Standards and Certifications



Miscellaneous

- Robust housing with screw brackets for secure fixing
- Built-in magnets for easy mounting on metal surfaces
- Both horizontal and vertical mounting allowed
- Power LED
- 1-year warranty (optional 3-year extended warranty available)

Packaging

Netto weight: 96g
 Items per carton 1 or 10 pcs

Mechanical dimensions

LxWxH: 94 x 76 x 36 mm
 Screw fixation: 54 x 69,7 mm

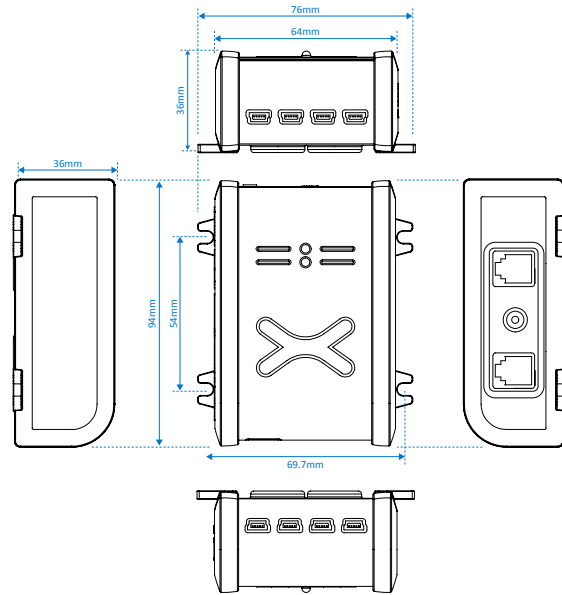

Hardware interfaces

- 1-8 X-talk interface, address 1-8
- 9. ShopBus RJ25 socket - In
- 10. ShopBus RJ25 socket - Out
- 11. 5V Power input 2.5mm DC socket

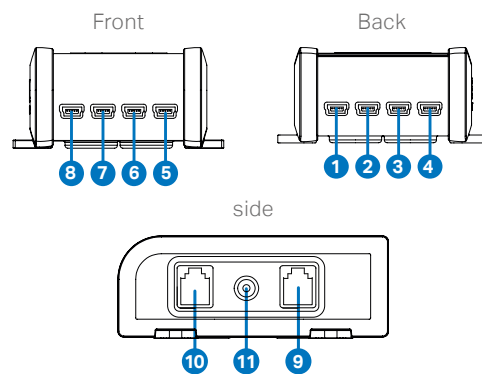

Ordering information

Product ID	Description	Quantity
SM-100	ShopBus module, ShopBus interface, 8x X-talk interface	1 pc

Nexmosphere

High Tech Campus 10 (Mμ building) T +31 40 240 7070
 5656 AE Eindhoven • The Netherlands E sales@nexmosphere.com

© 2017-2020 Nexmosphere. All rights reserved. v2.0 / 05-20
 All content contained herein is subject to change without prior notice.